

Wheatlands Metropolitan District

PO Box 370750 Denver, CO 80237
303.351.5411

Submit online: <https://home.amihoa.com/>

Application for Home Improvements and Modifications

In an effort to provide and protect each individual homeowner's rights and property values, it is required that any homeowner or group of owners considering improvement(s) and/or change(s) to their home or property submit an "Application for Home Improvements and Modifications" to the Design Control Committee (DCC). If any change is made that has not been approved, per the governing documents, the DISTRICT may require an owner to change or remove an improvement. **In addition, plans, sketches, drawings, illustrations, photographs, dimensions, and material samples should be provided to sufficiently describe the project in detail.**

Homeowners Information

Name:	Date:	Lot/Block:
Property Address	Email	
Home Phone No.	Work Phone No.	
Mailing Address (if different)	Alternative Contact Person/Number:	

Please Circle Type of Request:

- | | | | | | |
|----------------------|------------------------|----------------|--------------|---------------------|------------------|
| Back-yard Landscape | AC/Swamp Cooler | Awning | Dog Run | Exterior Lighting | Fence |
| Front-yard Landscape | Outdoor Fireplace | Gazebo/Pergola | Greenhouse | Exterior Painting | Trees |
| Retaining Wall | Play Equipment | Patio/Deck | Pool/Spa | Playhouse/Swing Set | Roofing |
| Room/House Addition | Satellite Dish | Skylight | Solar Panels | Storage Areas | Storage Building |
| Vegetable Garden | OTHER: Describe Below: | | | | |

Details:

PAINTING: Please submit a photo of the exterior of your house and label each section of your house with the new paint color(s).

Main Body Color	Secondary Body Color
Trim Color (include soffit, fascia boards, and window trim)	Accent Color (Includes shutters, windows hoods & exterior doors)

STORAGE BUILDING:

Plot map must be included with Application showing location of building on map.

Height of building :

Square footage of building:

Dimensions of building:

State location/placement of building:

Please include a sample of all improvements! (Example: Paint chip/swab/swatch, roofing shingle, siding sample, solar screen sample, etc.) In signing this application, I certify that all the information provided by me in connection with my application, whether on this document or not, is true and complete. I understand that any misstatements, falsification or omission of information shall be grounds for denial of this application. I further understand that the Design Control Committee has thirty (30) days upon receipt to review my application and I agree not to begin property improvements or modifications until the Committee notifies me, in writing, of their decision. District approval does not substitute for any County/State required permits. Owner is responsible for adhering to all Local/County/State guidelines. I have answered, truthfully, all questions pertaining to the proposed mentioned improvement or modification and have attached all samples, plans and permits required.

Homeowners Signature (REQUIRED)	Date
Improvement Start Date	Improvement Completion Date

Please return application to:

AMI- Advanced HOA
 PO Box 370750
 Denver, CO 80237

Special Note: Please make sure that your plans are complete with all needed materials. Incomplete plans will be Denied and returned.

Design Control Committee Use Only

Recommendation of the Committee: Approved Approved w/ Conditions Denied

Comments/Conditions/Reason for Denial:

DCC Name:

Date

DCC Signature:

OFFICE USE ONLY

DATE RECEIVED:

ACKNOWLEDGEMENT LETTER:

APPROVAL DATE:

APPROVAL LETTER SENT:

NOTES

- 1) WE WILL COMMIT TO A 100% UNDERGROUND AUTOMATIC IRRIGATION SYSTEM PER CITY OF AURORA CODE.
- 2) WE WILL COMMIT TO 1 CUBIC YARD OF WOOD MULCH PER 90 SQ. FEET OF BED AT A 4" DEPTH MINIMUM. ROCK OR STONE MULCH SHALL BE 3/4" MINIMUM TO COBBLE SIZE AT A 3" MINIMUM DEPTH. NO HIGH CONTRAST ROCK MULCH PATTERNS WILL BE USED.
- 3) 3 CUBIC YDS. PER 1000 SQ. FEET OF SOIL AMENDMENTS WILL BE INSTALLED AND TILLED INTO THE TOP 6" OF SOIL IN ALL LANDSCAPE AREAS.
- 3) EDGER SHALL BE (DESCRIBE THE TYPE OF EDGER THAT YOU WILL USE)
- 4) FENCE WILL BE THE APPROVED WHEATLANDS RAIL FENCE REFERENCED IN SCHEDULE 1.

CALCULATIONS FOR 50% BED COVERAGE

- 1) CALCULATE THE TOTAL SQUARE FOOTAGE OF THE BED/MULCH AREA.
(EX. TOTAL BED SQUARE FOOTAGE = 750 SF)
- 2) MULTIPLY THAT NUMBER BY 50%
(750 SF TIMES 50% = 375 SF)
- 3) SUBTRACT 100 S.F. PER EACH EVERGREEN TREE PROPOSED WITHIN THE BED AREA
(1 EVERGREEN TREE 375 MINUS 100 = 275)
- 4) DIVIDE THAT NUMBER BY 16 SF (THE AREA OF ONE SHRUB) = THE NUMBER OF REQUIRED SHRUBS
(275 DIVIDED BY 16 = 17 SHRUBS REQUIRED)
- 5) SHRUBS = 5 GAL CONTAINERS MINIMUM. THREE 1 GAL ORNAMENTAL OR PERENNIAL CONTAINERS = 1 SHRUB

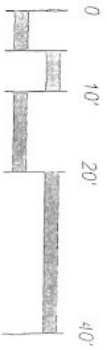

SCALE 1" = 20'

NORTH

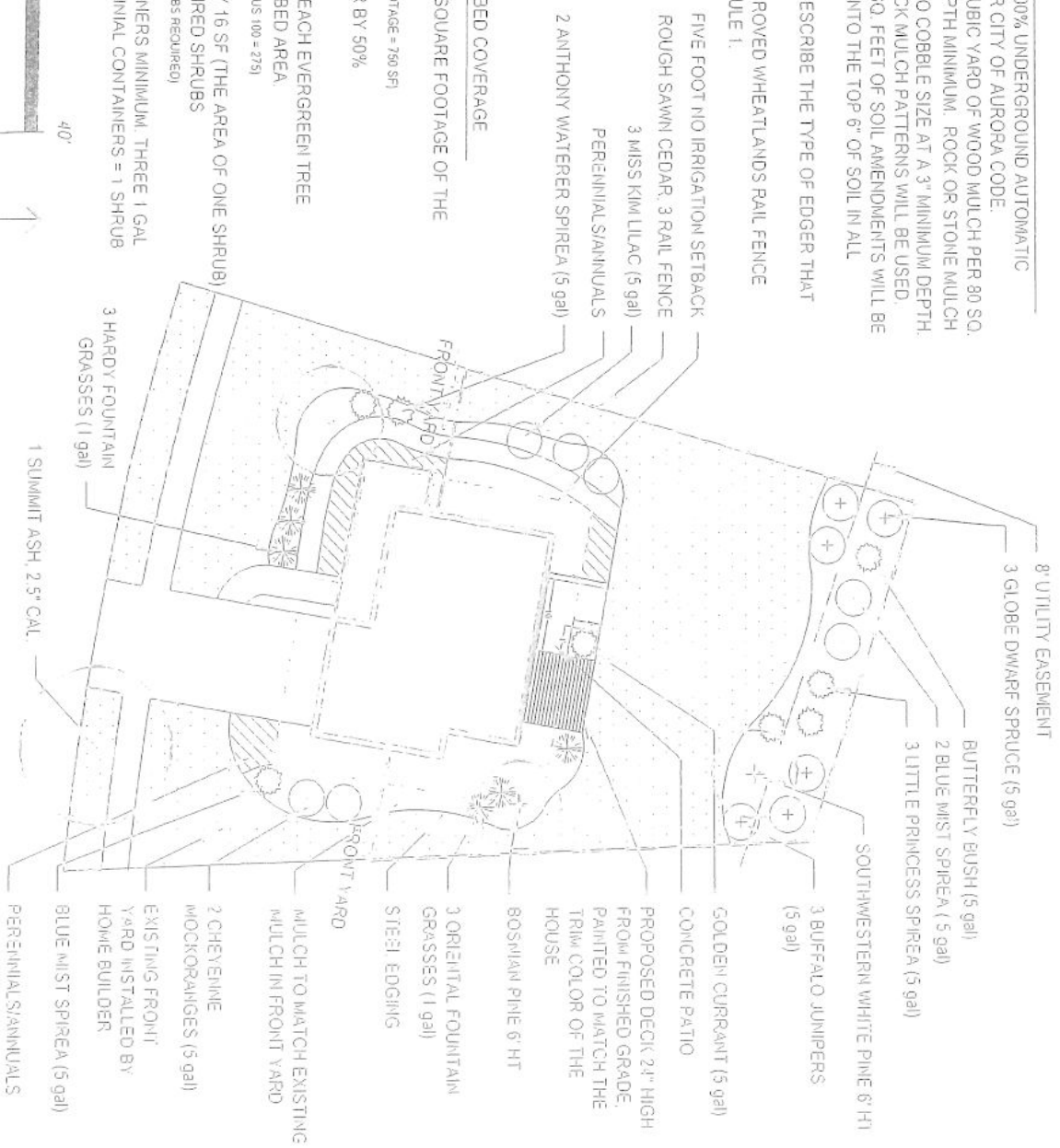

**WHEATLANDS
SAMPLE LANDSCAPE PLAN**

WHEATLANDS METRO DISTRICT

NOTICE OF COMPLETION

Applicant's written notice of completion to the management company, as stated in Section 10.15 & 10.16
"The applicant shall give written notice of completion to the management company. The Architectural Review Committee shall have the right to inspect any improvement to the property prior to or after completion, within 60 days after the management gets the Notice of Completion."

HOMEOWNER:

ADDRESS: _____ Phone: _____

ITEM(S) APPROVED & INSTALLED:

APPROVAL DATE: _____ COMPLETION DATE: _____

Upon completion of the project, submit this form and pictures of the project completed to:

AMI- Advanced HOA
PO Box 370750
Denver, CO 80237

Submit Online: <https://home.amihoa.com/>

OR
Email: wheatlands@amihoa.com